



# technical data

**FTK/XS-DVML**



**Wall Mounted,  
Inverter Controlled Unit**

air conditioning systems

# Split Sky Air

# Split - Sky Air



ISO14001 assures an effective environmental management system in order to help protect human health and the environment from the potential impact of our activities, products and services and to assist in maintaining and improving the quality of the environment



Daikin units comply with the European regulations that guarantee the safety of the product.



Daikin Europe N.V. is approved by LRQA for its Quality Management System in accordance with the ISO9001 standard. ISO9001 pertains to quality assurance regarding design, development, manufacturing as well as to services related to the product.



Daikin Europe N.V. participates in the Eurovent Certification Programme for Air Conditioners (AC), Liquid Chilling Packages (LCP) and Fan Coil Units (FC); the certified data of certified models are listed in the Eurovent Directory.

Specifications are subject to change without prior notice.

## **DAIKIN EUROPE N.V.**

Zandvoordestraat 300  
B - 8400 Ostend Belgium  
[www.daikineurope.com](http://www.daikineurope.com)

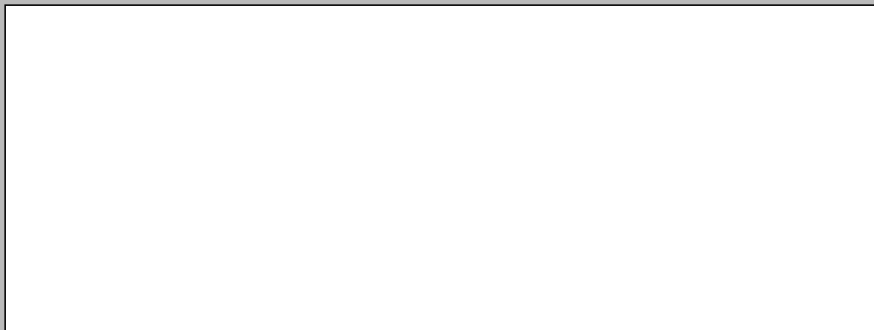

# TABLE OF CONTENTS

## FTK/XS-DVML

1	Features.....	2
2	Specifications.....	3
	FTKS-D	
	Nominal capacity and power input .....	3
	Technical Specifications .....	3
	Electrical Specifications .....	4
	FTXS-D	
	Nominal capacity and power input .....	4
	Technical Specifications .....	5
	Electrical Specifications .....	6
3	Dimensional drawing & centre of gravity.....	7
	Dimensional drawing .....	7
	Centre of gravity .....	8
4	Piping diagram.....	9
5	Wiring diagram .....	10
6	Sound data.....	11
	Sound pressure spectrum .....	11

# 1 Features

1

- Comfort mode reassures draught-free operation
- Vertical auto-swing function moves the discharge flaps up and down for efficient air distribution throughout the room
- You have the choice out of 5 fan speeds to select
- Daikin's special dry programme reduces humidity in the room without variation in room temperature
- Night set mode saves energy by preventing overcooling or overheating during night time
- Indoor unit silent operation: "Silent" button on the remote control lowers the operation sound of the indoor unit by 3dB(A).
- Powerful mode can be selected for rapid cooling
- The new titanium apatite photocatalytic air purification filter increases the active surface area for effective purification and deodorisation
- ECONO mode decreases power consumption so that other appliances that need large power supply can be used
- The movement sensor saves power consumption in unoccupied rooms
- Daikin remote controls give you easy control at your fingertips.

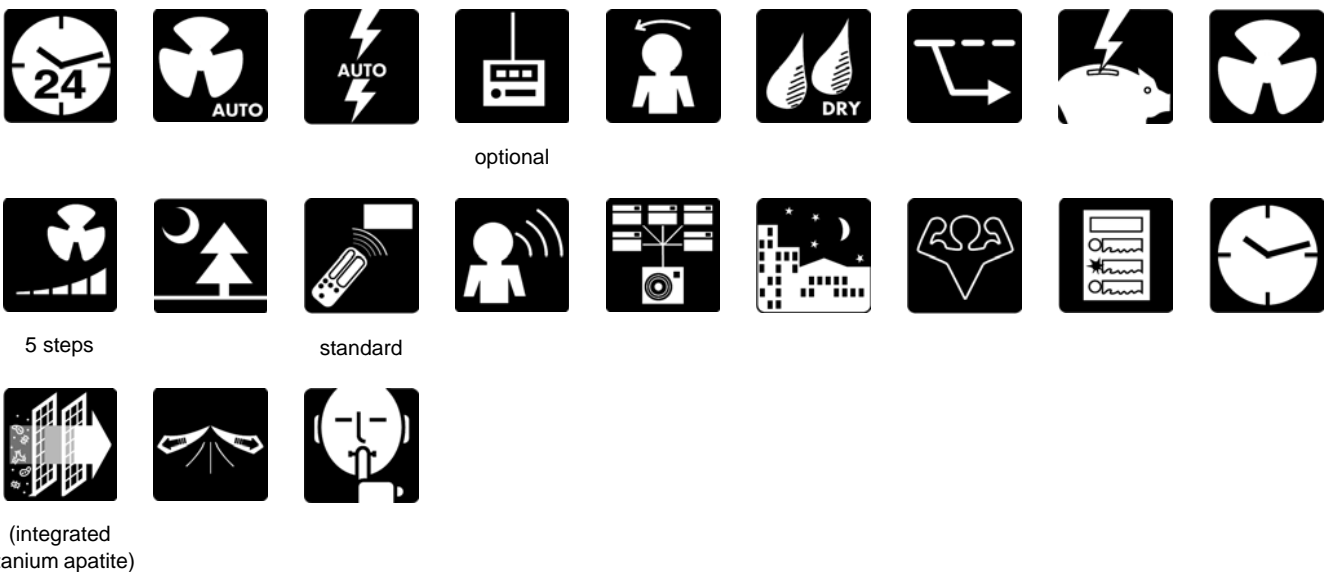

## 2 Specifications

2-1 NOMINAL CAPACITY AND POWER INPUT					
For indoor units only:					
INDOOR UNITS			FTKS20DVML	FTKS25DVML	FTKS35DVML
NOMINAL INPUT	Cooling	kW	0.035	0.035	0.040

For combination indoor + outdoor units (air cooled):					
COOLING ONLY - INVERTER CONTROLLED (air cooled)			FTKS20DVML	FTKS25DVML	FTKS35DVML
			RKS20DVMB	RKS25DVMB	RKS35DVMB
Cooling capacity	min-nom-max	kW	1.2~2.0~2.6	1.3~2.5~3.0	1.4~3.4~3.8
Nominal input	min-nom-max	kW	0.30~0.49~0.83	0.30~0.685~0.96	0.30~1.045~1.27
EER			4.08	3.65	3.25
Energy label			A	A	A
Annual energy consumption	Cooling	kWh	245	343	523

2-2 TECHNICAL SPECIFICATIONS				FTKS20DVML	FTKS25DVML	FTKS35DVML	
Casing	Colour			White + silver line			
Dimensions	Packing	Height	mm	340	340	340	
		Width	mm	855	855	855	
		Depth	mm	265	265	265	
	Unit	Height	mm	283	283	283	
		Width	mm	800	800	800	
		Depth	mm	195	195	195	
Weight	Machine Weight		kg	9.0	9.0	9.0	
	Gross Weight		kg	12.0	12.0	12.0	
Heat Exchanger	Dimensions	Length	mm	610	610	610	
		Nr of Rows			2	2	2
		Fin Pitch	mm	1.40	1.40	1.40	
		Nr of Stages			12	12	12
	Tube type		Hi-XA (7)				
	Fin		Type	ML fin (Multi louver)			
Fan	Type			Cross flow fan			
Air Flow Rate	Cooling	High	m³/min	8.7	8.7	8.9	
		Medium	m³/min	6.7	6.7	6.9	
		Low	m³/min	4.7	4.7	4.9	
		Silent Operation	m³/min	3.9	3.9	4.0	
Fan	Motor	Quantity		1	1	1	
		Model		KFD-280-40-8B			
		Number of steps		5 steps, silent and auto			
Motor	Speed (cooling)	High	rpm	1290	1290	1310	
		Medium	rpm	1050	1050	1070	
		Low	rpm	810	810	830	
		Silent Operation	rpm	710	710	730	
Fan	Motor	Output (high)	W	40	40	40	
Cooling	Sound Power	High	dBA	56.0	56.0	57.0	
		Low	dBA	25.0	25.0	26.0	
	Sound Pressure	High	dBA	38.0	38.0	39.0	
		Silent Operation	dBA	22.0	22.0	23.0	

2-2 TECHNICAL SPECIFICATIONS				FTKS20DVML	FTKS25DVML	FTKS35DVML
Heating	Sound Power	High	dBA	56.0		
	Sound Pressure	High	dBA	38.0		
		Low	dBA	25.0		
		Silent Operation	dBA	22.0		
Refrigerant	Type			R-410A		
Piping connections	Liquid (OD)	Diameter (OD)	mm	6.4	6.4	6.4
	Gas	Diameter (OD)	mm	9.5	9.5	9.5
	Drain	Diameter (OD)	mm	18	18	18
	Heat Insulation			Both liquid and gas pipes		
Air Filter				Removable/washable/Mildew proof		
Air direction control				Left, right, up and downwards		
Temperature control				Microcomputer control		
Standard Accessories	Item			Titanium apatite photocatalytic air purification filter		
	Quantity			2	2	2
	Item			Operation manual		
	Quantity			1	1	1
	Item			Installation manual		
	Quantity			1	1	1
	Item			Infrared remote control		
	Quantity			1	1	1
	Item			Batteries		
	Quantity			2	2	2
	Item			Remote control holder		
	Quantity			1	1	1
	Item			Indoor unit fixing screws		
	Quantity			2	2	2
	Item			Mounting plate		
Quantity			1	1	1	

2-3 ELECTRICAL SPECIFICATIONS				FTKS20DVML	FTKS25DVML	FTKS35DVML
Power Supply	Name			VM	VM	VM
	Phase			1	1	1
	Frequency		Hz	50/60		
	Voltage		V	220-240/220-230	220-240/220-230	220-240/220-230
Current	Nominal running current (RLA)	Cooling	A	0.16	0.16	0.18
Wiring connections	For Power Supply	Quantity		3	3	3
		Remark		4 for interunit wiring(included earth wiring)	4 for interunit wiring (included earth wiring)	4 for interunit wiring (included earth wiring)
Voltage range	Minimum			-10%		
	Maximum			+10%		
Power Supply Intake				Outdoor unit only		

2-4 NOMINAL CAPACITY AND POWER INPUT						
For indoor units only:						
INDOOR UNITS			FTXS20DVML	FTXS25DVML	FTXS35DVML	
NOMINAL INPUT	Cooling	kW	0.035	0.035	0.040	
	Heating	kW	0.035	0.035	0.040	

For combination indoor + outdoor units (air cooled):						
COOLING ONLY - INVERTER CONTROLLED (air cooled)			FTXS20DVML	FTXS25DVML	FTXS35DVML	
			RXS20DVMB	RXS25DVMB	RXS35DVMB	
Cooling capacity	min-nom-max	kW	1.3~2.0~2.6	1.3~2.5~3.0	1.4~3.4~3.8	
Heating capacity	min-nom-max	kW	1.3~2.7~4.1	1.3~3.4~4.5	1.4~4.0~5.0	
Nominal input	Cooling	min-nom-max	0.30~0.49~0.83	0.30~0.685~0.96	0.30~1.045~1.27	
	Heating	min-nom-max	0.29~0.66~1.30	0.29~0.92~1.43	0.31~1.155~1.56	
EER			4.08	3.65	3.25	
COP			4.09	3.70	3.46	

Energy label	Cooling		A	A	A
	Heating		A	A	B
Annual energy consumption	Cooling	kWh	245	343	523

2-5 TECHNICAL SPECIFICATIONS				FTXS20DVML	FTXS25DVML	FTXS35DVML	
Casing	Colour			White + silver line	White + silver line	White + silver line	
Dimensions	Packing	Height	mm	340	340	340	
		Width	mm	855	855	855	
		Depth	mm	265	265	265	
	Unit	Height	mm	283	283	283	
		Width	mm	800	800	800	
		Depth	mm	195	195	195	
Weight	Machine Weight		kg	9.0	9.0	9.0	
	Gross Weight		kg	12.0	12.0	12.0	
Heat Exchanger	Dimensions	Length	mm	610	610	610	
		Nr of Rows			2	2	2
		Fin Pitch	mm	1.40	1.40	1.40	
		Nr of Stages			12	12	12
	Tube type			Hi-XA (7)	Hi-XA (7)	Hi-XA (7)	
	Fin	Type		ML fin (Multi louver)	ML fin (Multi louver)	ML fin (Multi louver)	
Fan	Type			Cross flow fan	Cross flow fan	Cross flow fan	
Air Flow Rate	Cooling	High	m <sup>3</sup> /min	8.7	8.7	8.9	
		Medium	m <sup>3</sup> /min	6.7	6.7	6.9	
		Low	m <sup>3</sup> /min	4.7	4.7	4.8	
		Silent Operation			3.9	3.9	4.0
	Heating	High	m <sup>3</sup> /min	9.4	9.4	9.7	
		Medium	m <sup>3</sup> /min	7.6	7.6	7.9	
		Low	m <sup>3</sup> /min	5.8	5.8	6.0	
		Silent Operation			5.0	5.0	5.2
Fan	Motor	Quantity		1	1	1	
		Model		KFD-280-40-8B	KFD-280-40-8B	KFD-280-40-8B	
		Number of steps		5 steps, silent and auto	5 steps, silent and auto	5 steps, silent and auto	
Motor	Speed (cooling)	High	rpm	1290	1290	1310	
		Medium	rpm	1050	1050	1070	
		Low	rpm	810	810	830	
		Silent Operation			710	710	730
	Speed (heating)	High	rpm	1320	1320	1360	
		Medium	rpm	1120	1120	1150	
		Low	rpm	920	920	940	
		Silent Operation			820	820	840
Fan	Motor	Output (high)	W	40	40	40	
Cooling	Sound Power	High	dBA	56.0	56.0	57.0	
		Low	dBA	25.0	25.0	26.0	
	Sound Pressure	High	dBA	38.0	38.0	39.0	
		Silent Operation	dBA	22.0	22.0	23.0	
Heating	Sound Power	High	dBA	56.0	56.0	57.0	
		Low	dBA	28.0	28.0	29.0	
	Sound Pressure	High	dBA	38.0	38.0	39.0	
		Silent Operation	dBA	25.0	25.0	26.0	
Refrigerant	Type			R-410A	R-410A	R-410A	

2-5 TECHNICAL SPECIFICATIONS				FTXS20DVML	FTXS25DVML	FTXS35DVML
Piping connections	Liquid (OD)	Diameter (OD)	mm	6.4	6.4	6.4
	Gas	Diameter (OD)	mm	9.5	9.5	9.5
	Drain	Diameter (OD)	mm	18	18	18
	Heat Insulation			Both liquid and gas pipes	Both liquid and gas pipes	Both liquid and gas pipes
Air Filter				Removable/washable/Mildew proof	Removable/washable/Mildew proof	Removable/washable/Mildew proof
Air direction control				Left, right, up and downwards	Left, right, up and downwards	Left, right, up and downwards
Temperature control				Microcomputer control	Microcomputer control	Microcomputer control
Standard Accessories	Item			Titanium apatite photocatalytic air purification filter	Titanium apatite photocatalytic air purification filter	Titanium apatite photocatalytic air purification filter
	Quantity			2	2	2
	Item			Operation manual	Operation manual	Operation manual
	Quantity			1	1	1
	Item			Installation manual	Installation manual	Installation manual
	Quantity			1	1	1
	Item			Infrared remote control	Infrared remote control	Infrared remote control
	Quantity			1	1	1
	Item			Batteries	Batteries	Batteries
	Quantity			2	2	2
	Item			Remote control holder	Remote control holder	Remote control holder
	Quantity			1	1	1
	Item			Indoor unit fixing screws	Indoor unit fixing screws	Indoor unit fixing screws
	Quantity			2	2	2
	Item			Mounting plate	Mounting plate	Mounting plate
Quantity			1	1	1	

2-6 ELECTRICAL SPECIFICATIONS				FTXS20DVML	FTXS25DVML	FTXS35DVML
Power Supply	Name			VM	VM	VM
	Phase			1	1	1
	Frequency	Hz		50/60	50/60	50/60
	Voltage	V		220-240/220-230	220-240/220-230	220-240/220-230
Current	Nominal running current (RLA)	Cooling	A	0.16	0.16	0.18
		Heating	A	0.16	0.16	0.18
Wiring connections	For Power Supply	Quantity			3	3
		Remark		4 for interunit wiring (included earth wiring)	4 for interunit wiring (included earth wiring)	4 for interunit wiring (included earth wiring)
Voltage range	Minimum			-10%	-10%	-10%
	Maximum			+10%	+10%	+10%
Power Supply Intake				Outdoor unit only	Outdoor unit only	Outdoor unit only

NOTES

- 1 Sound values are measured in an anechoic room.
- 2 Sound pressure level is a relative value, depending on the distance and acoustic environment. For more details, please refer to sound level drawings of this chapter.
- 3 The sound power level is an absolute value indicating the power which a sound source generates.



### 3 Dimensional drawing & centre of gravity

#### 3 - 1 Dimensional drawing

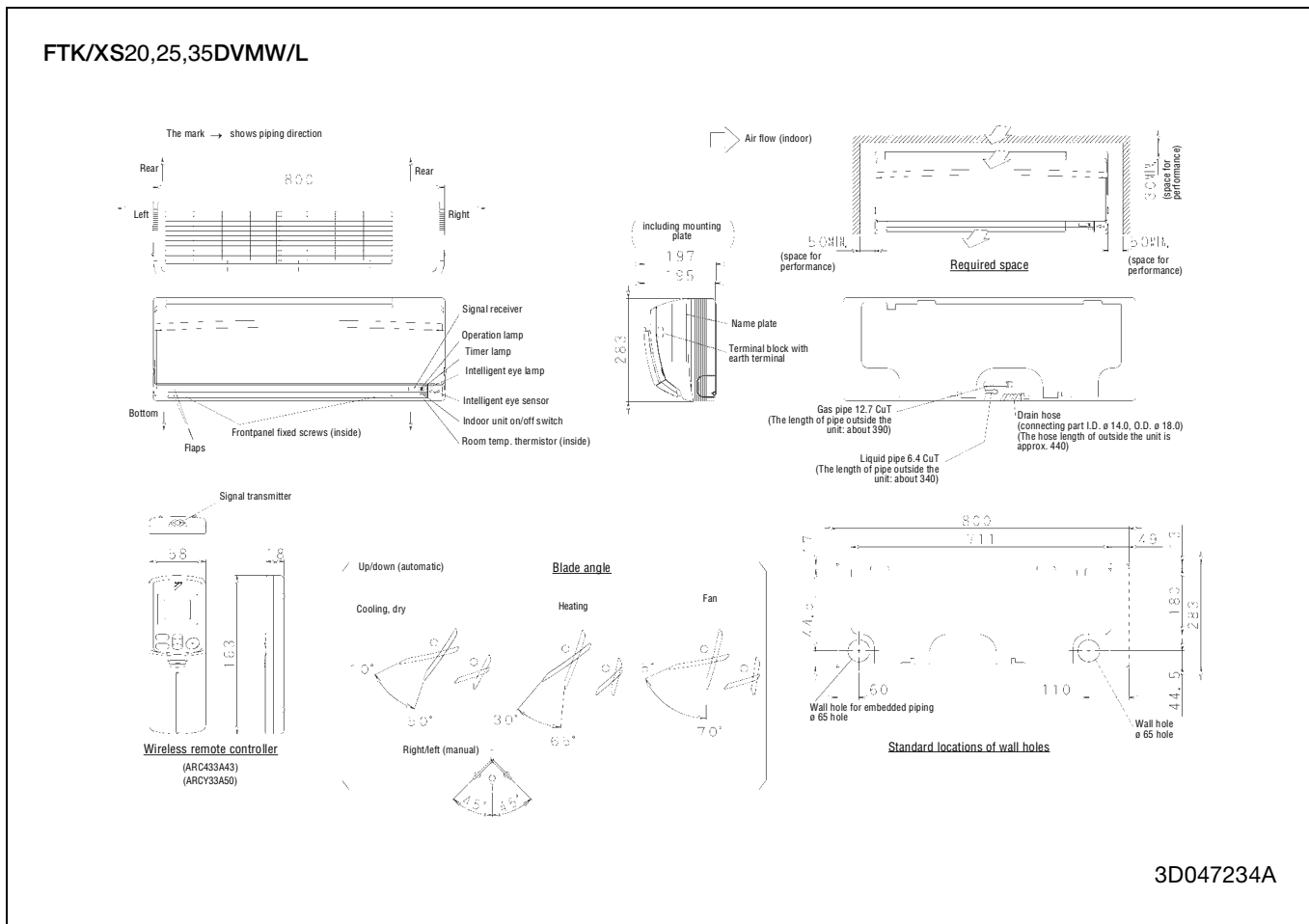

### 3 Dimensional drawing & centre of gravity

#### 3 - 2 Centre of gravity

3

FTK/XS20,25,35DVMW/L

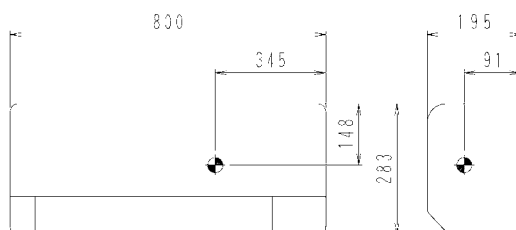

4D048210

# 4 Piping diagram

FTK/XS20,25,35DVMW/L

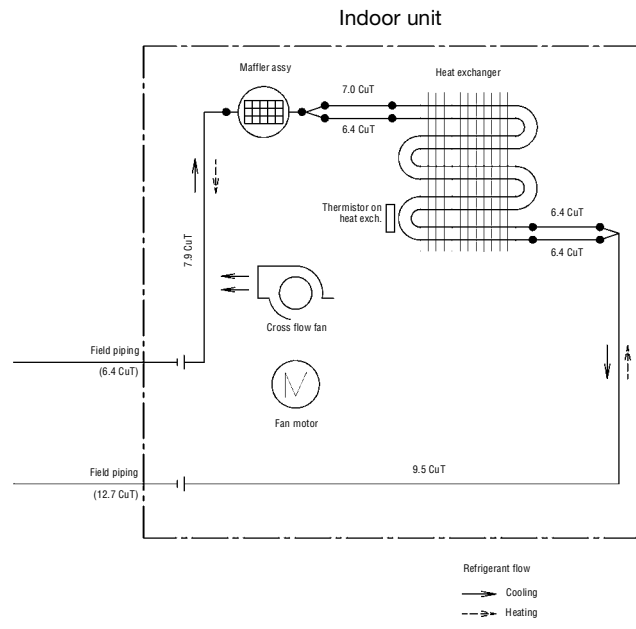

4D047912

# 5 Wiring diagram

5

FTK/XS20,25,35DVMW/L

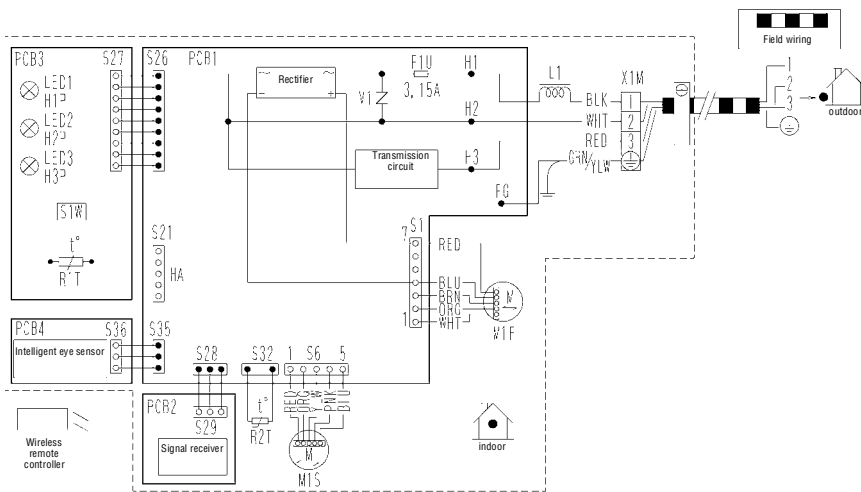

## LEGEND

	Protective earth
FG	Frame ground
F1U	Fuse
H1P~H3P	Pilot lamp
L1	Coil
M1F	Fan motor
M1S	Swing motor
PCB1~PCB4	Printed circuit board
R1T, R2T	Thermistor
S1~S38	Connector
S1W	Operation switch
X1M	Terminal strip

## NOTES

- 1 Size: length 70 x width 120.
- 2 Refer to purchasing specification AS303002, unless otherwise specified.
- 3 This drawing was drawn on CAD system.
- 4 Caution: Note that operation will restart automatically if the main power supply is turned off and then back on again.

3D047523

## 6 Sound data

### 6 - 1 Sound pressure spectrum

FTKS20,25DVMW/L

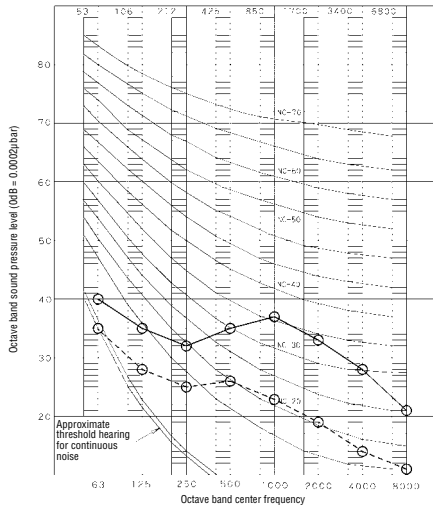

**NOTES**

- 1 Measurement was taken in an anechoic room.
- 2 The operation noise measuring method is in accordance with JISC9612.
- 3 Operating conditions:  
Power source = 230 V, 50 Hz  
o-----o H (A = 38) and o- - - -o L (A = 25)
- 4 Operation noise differs with operation and ambient conditions.

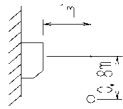

Location of microphone

4D048244

FTKS35DVMW/L

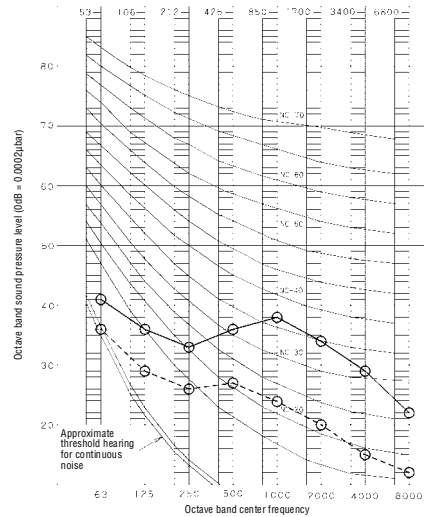

**NOTES**

- 1 Measurement was taken in an anechoic room.
- 2 The operation noise measuring method is in accordance with JISC9612.
- 3 Operating conditions:  
Power source = 230/220 V, 50/60 Hz  
o-----o H (A = 39) and o- - - -o L (A = 26)
- 4 Operation noise differs with operation and ambient conditions.

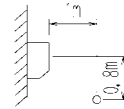

Location of microphone

4D048245A

# 6 Sound data

## 6 - 1 Sound pressure spectrum

6

### FTXS20,25D

